

# STIMULAN<sup>®</sup>

## PREPARATION GUIDE FOR STIMULAN Rapid Cure

### Mixing solution provided

Use the mixing solution from the tube provided in the pack. Do not add any other fluid.



**Warning:** Concurrent use of locally administered antibiotics may affect the setting time as exemplified below for 10cc of **STIMULAN** Rapid Cure. The mixing of antibiotics with the **STIMULAN** Rapid Cure device has not been assessed by a European medicines Competent Authority and is considered off-label usage of the medicinal product and of the device. To do so is at the professional risk of the surgeon/healthcare professional.

### Combination of powder and liquid antibiotics

If using liquid antibiotics, the mixing solution provided in the pack should not be used.

#### Vancomycin\* (powder) 1g and gentamicin\* (liquid) 240mg DO NOT USE MIXING SOLUTION PROVIDED

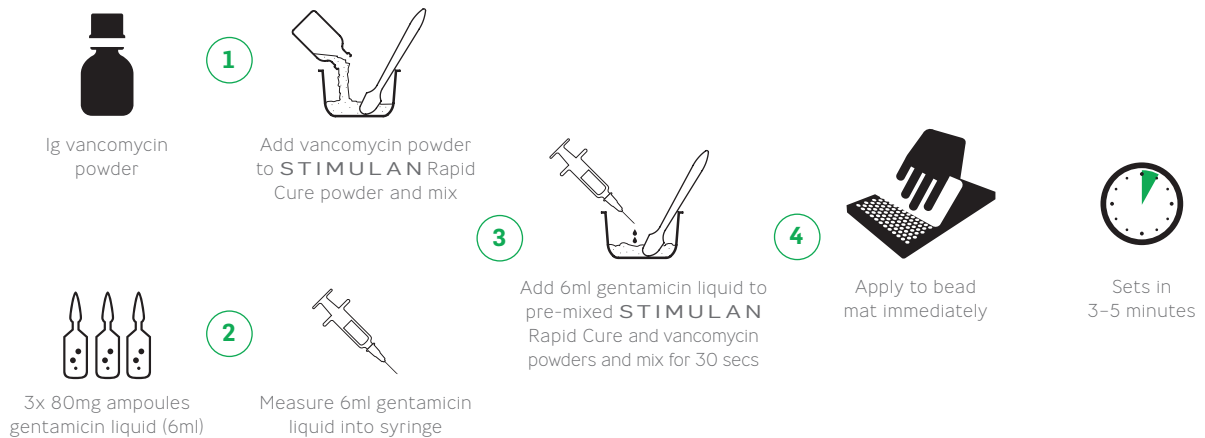

#### Vancomycin\* (powder) 1g and tobramycin\* (liquid) 240mg DO NOT USE MIXING SOLUTION PROVIDED

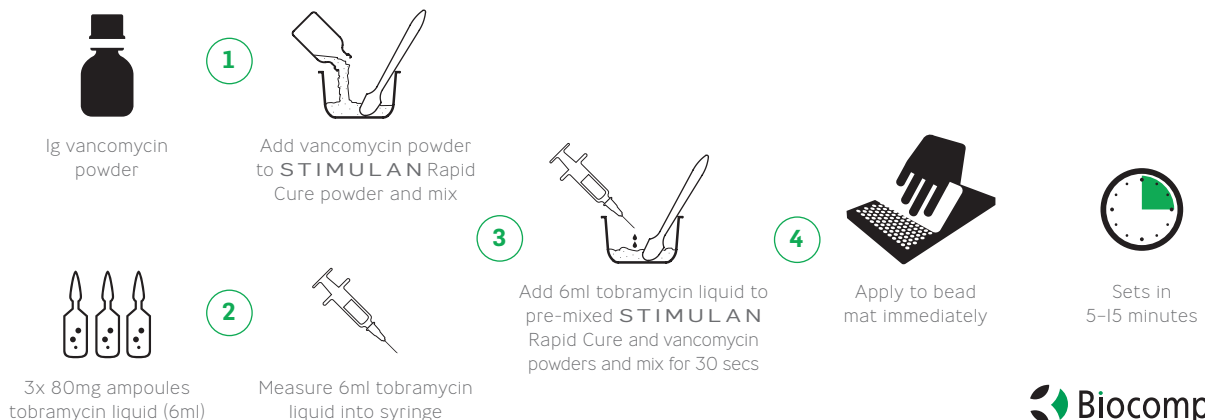

## Powdered antibiotics

The mixing solution provided in the pack should be used. Do not add any other fluids.



1g vancomycin powder

1



Add vancomycin powder to **STIMULAN** Rapid Cure powder and mix

2

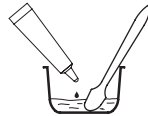

Add **STIMULAN** Rapid Cure mixing solution and mix for 30 secs

3



Apply to bead mat immediately



Sets in 3-5 minutes

## Powdered antibiotics with extended setting times

Some antibiotics may delay the setting time significantly. This technique ensures a faster set time.

### Tobramycin\* (powder) 1.2g



1.2g tobramycin powder

1



Add mixing solution to **STIMULAN** Rapid Cure powder Mix for 40 secs

2



Add tobramycin powder to **STIMULAN** Rapid Cure powder and mix for 30 secs

3



Apply to bead mat immediately



Sets in 10-20 minutes

## Liquid antibiotics

If using liquid antibiotics, the mixing solution provided in the pack should not be used.

### Gentamicin\* (liquid) 240mg DO NOT USE MIXING SOLUTION PROVIDED



3x 80mg ampoules gentamicin liquid (6ml)

1



Measure 6ml gentamicin liquid into syringe

2

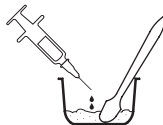

Add 6ml gentamicin liquid to **STIMULAN** Rapid Cure powder and mix for 30 secs

3



Apply to bead mat immediately



Sets in 3-5 minutes

### Tobramycin\* (liquid) 240mg DO NOT USE MIXING SOLUTION PROVIDED



3x 80mg ampoules tobramycin liquid (6ml)

1



Measure 6ml tobramycin liquid into syringe

2

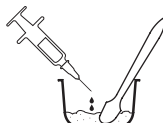

Add 6ml tobramycin liquid to **STIMULAN** Rapid Cure powder and mix for 30 secs

3



Apply to bead mat immediately



Sets in 5-15 minutes

CE 0088

\*Source Hospira

The treating physician is responsible for deciding the type and quantity of antibiotic used.

This brochure may include the use of **STIMULAN** or techniques that go beyond the current clearance / approval granted by the relevant regulatory authority. Please contact your local representative for further information.

©2016, Biocomposites and Stimulan are registered trademarks of Biocomposites Ltd. All rights reserved.

No unauthorised copying, reproduction, distributing or republication is allowed unless prior written permission is granted by the owner, Biocomposites Ltd.

Patents granted: GB2367552, EP I204599 B1, US 6780391, EP 2594231 B1, US 8883063, ZL 20121046617.X, GB2496710.

MA0079R2 Not for distribution in the USA.